

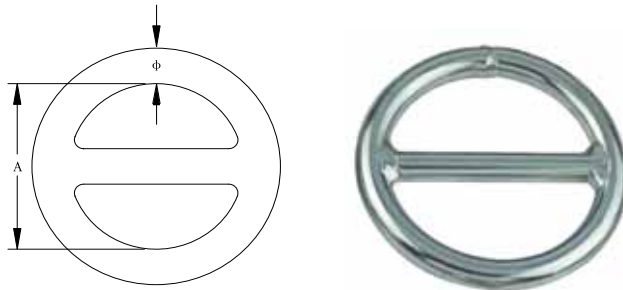

ROUND RING (CENTER CROSS BAR) WELDED, SS304 OR SS316



Part No. 304	Part No. 316	φ mm	A mm	SWL kgs	BL kgs
39332	39341	6.00	30.00	675	2700
39333	39342	6.00	40.00	675	2700
39334	39343	8.00	40.00	1250	5000
39335	39344	8.00	50.00	1250	5000
39336	39345	9.00	60.00	1550	6200
39337	39346	10.00	60.00	2125	8500
39338	39347	10.00	70.00	2125	8500
39339	39348	10.00	80.00	2125	8500
39340	39349	12.00	80.00	2500	10000

WIRE SUPPORT D-RING, SS304 OR SS316

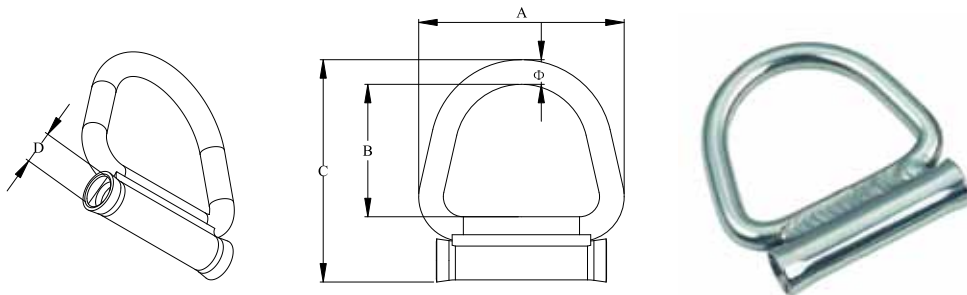

Part No. 304	Part No. 316	φ mm	A mm	B mm	C mm	D mm
39388	39389	8.00	66.00	43.00	71.00	10.00