

MARINE AND ARCHITECTURAL HARDWARE

QUICK LINK, SS304 OR SS316

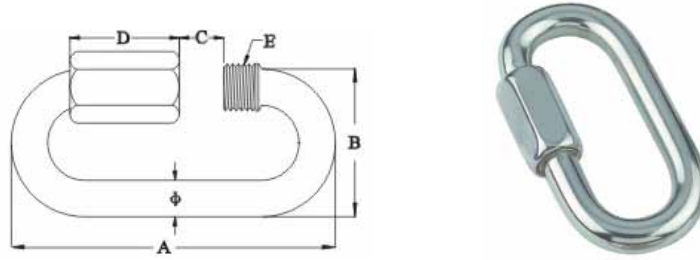

Part No. 304	Part No. 316	ϕ mm	A mm	B mm	C mm	D mm	E mm	SWL kgs	BL kgs
39011	39023	3.50	36.00	17.00	5.00	12.00	M5x1.90	220	1100
39012	39024	4.00	39.50	19.50	6.00	14.00	M6x1.00	280	1400
39013	39025	5.00	49.50	23.00	7.00	17.00	M7x1.00	450	2250
39014	39026	6.00	57.00	26.50	8.00	20.00	M9x1.25	650	3250
39015	39027	7.00	66.00	30.00	9.00	22.50	M10x1.25	900	4500
39016	39028	8.00	74.00	33.50	10.00	24.00	M11x1.25	1100	5500
39017	39029	9.00	80.00	37.00	11.00	27.00	M12x1.25	1400	7000
39018	39030	10.00	89.00	40.50	12.00	30.00	M13x1.25	1800	9000
39019	39031	12.00	104.50	47.50	14.00	34.00	M15x1.50	2500	12500
39020	39032	14.00	121.00	54.50	17.00	38.50	M17x1.50	3500	17500
39021	39033	16.00	140.00	61.50	19.00	45.00	M19x1.50	4500	22500
39022	39034	18.00	157.00	68.50	23.00	52.00	M22x1.50	5400	27000

QUICK LINK WIDE JAW, SS304 OR SS316

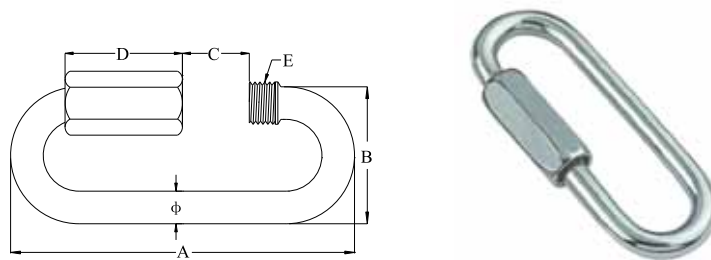

Part No. 304	Part No. 316	ϕ mm	A mm	B mm	C mm	D mm	E mm	SWL kgs	BL kgs
39035	39047	3.50	46.00	17.75	10.00	16.00	M5x0.90	200	1000
39036	39048	4.00	53.00	20.50	11.50	19.00	M6x1.00	250	1250
39037	39049	5.00	62.00	24.00	13.00	22.00	M7x1.00	400	2000
39038	39050	6.00	70.50	28.00	14.50	25.00	M9x1.25	580	2900
39039	39051	7.00	79.00	31.50	16.00	28.00	M10x1.25	800	4000
39040	39052	8.00	88.00	35.00	17.50	31.50	M11x1.25	980	4900
39041	39053	9.00	95.00	38.50	19.00	33.00	M12x1.25	1250	6250
39042	39054	10.00	105.50	42.00	20.50	36.00	M13x1.25	1600	8000
39043	39055	12.00	124.00	49.00	23.50	43.00	M15x1.50	2200	11000
39044	39056	14.00	142.00	56.00	26.50	49.00	M17x1.50	3100	15500
39045	39057	16.00	161.00	63.00	29.50	54.00	M19x1.50	4000	20000
39046	39058	18.00	176.50	70.50	32.50	62.00	M22x1.50	4900	24500



DELTA SHAPE QUICK LINK, SS304 OR SS316

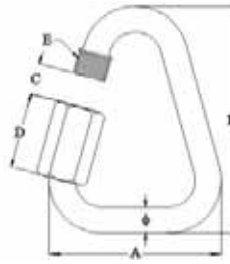

Part No. 304	Part No. 316	φ mm	A mm	B mm	C mm	D mm	E mm	SWL kgs	BL kgs
39059	39071	3.50	31.00	36.00	5.00	12.00	M5x0.90	150	750
39060	39072	4.00	35.00	40.00	6.00	13.00	M6x1.00	200	1000
39061	39073	5.00	40.00	48.00	7.00	17.00	M7x1.00	325	1650
39062	39074	6.00	47.00	56.00	8.00	20.00	M9x1.25	450	2250
39063	39075	7.00	51.00	63.00	9.00	22.50	M10x1.25	625	3125
39064	39076	8.00	56.00	73.00	10.00	24.00	M11x1.25	770	3850
39065	39077	9.00	60.00	78.00	11.00	27.00	M12x1.25	980	4900
39066	39078	10.00	66.00	87.00	12.00	30.00	M13x1.25	1250	6250
39067	39079	12.00	75.00	104.00	15.00	33.00	M15x1.50	1750	8750
39068	39080	14.00	85.00	123.00	17.00	38.50	M17x1.50	2450	12250
39069	39081	16.00	93.00	138.00	19.00	45.00	M19x1.50	3150	15750
39070	39082	18.00	102.00	155.00	23.00	52.00	M22x1.50	4200	21000

PEAR SHAPE QUICK LINK, SS304 OR SS316

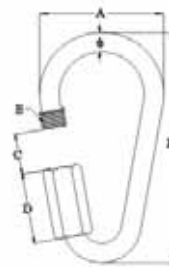

Part No. 304	Part No. 316	φ mm	A mm	B mm	C mm	D mm	E mm	SWL kgs	BL kgs
39083	39094	3.50	27.50	53.00	10.00	16.00	M5x0.90	130	650
39084	39095	4.00	32.00	61.00	11.50	19.00	M6x1.00	170	850
39085	39096	5.00	37.00	70.50	13.00	22.00	M7x1.00	270	1350
39086	39097	6.00	42.50	82.50	14.50	25.00	M9x1.25	400	2000
39087	39098	7.00	48.00	90.50	16.00	28.00	M10x1.25	550	2750
39088	39099	8.00	53.00	100.00	17.50	31.50	M11x1.25	660	3300
39089	39100	9.00	58.00	108.00	19.00	33.00	M12x1.25	840	4200
39090	39101	10.00	63.50	118.00	20.50	36.00	M13x1.25	1100	5500
39091	39102	12.00	76.00	144.00	23.50	43.00	M15x1.50	1500	7500
39092	39103	14.00	85.00	157.60	26.50	49.00	M17x1.50	2100	10500
39093	39104	16.00	95.50	176.50	29.50	54.00	M19x1.50	2700	13500

MARINE AND ARCHITECTURAL HARDWARE

QUICK LINK, SS304 OR SS316

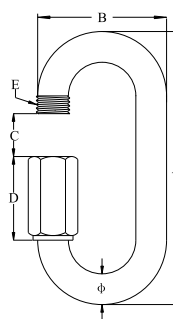

Part No. 304	Part No. 316	φ mm	A mm	B mm	C mm	D mm	E mm
39105	39111	3.00	35.00	16.50	6.00	12.00	M3.50x0.60
39106	30101	4.00	43.00	18.50	7.00	14.00	M4.50x0.75
39107	39112	5.00	52.00	22.50	8.50	18.00	M5.50x1.00
39108	30016	6.00	61.50	27.00	9.50	21.00	M6.50x1.00
39109	19440	8.00	77.00	35.50	11.00	25.00	M9.00x1.25
39110	30102	10.00	89.00	42.00	13.50	28.00	M10.50x1.25

SQUARE SHAPE QUICK LINK, SS304 OR SS316

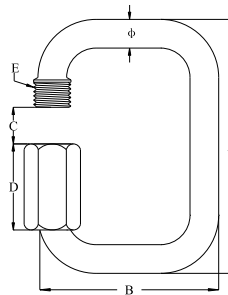

Part No. 304	Part No. 316	φ mm	A mm	B mm	C mm	D mm	E mm	SWL kgs	BL kgs
39113	39124	3.50	34.50	29.00	5.00	12.00	M5x0.90	150	750
39114	39125	4.00	39.50	33.00	5.50	14.00	M6x1.00	200	1000
39115	39126	5.00	47.50	38.00	6.50	17.00	M7x1.00	325	1625
39116	39127	6.00	55.00	43.00	7.50	20.00	M9x1.25	450	2250
39117	39128	7.00	63.50	48.00	8.50	22.50	M10x1.25	625	3125
39118	39129	8.00	71.00	53.00	10.00	24.00	M11x1.25	770	3850
39119	39130	9.00	78.00	58.00	11.00	27.00	M12x1.25	980	4900
39120	39131	10.00	88.50	63.00	12.00	30.00	M13x1.25	1250	6250
39121	39132	12.00	102.00	74.00	15.00	34.00	M15x1.50	1750	8750
39122	39133	14.00	117.00	85.00	17.00	38.50	M17x1.50	2100	10500
39123	39134	16.00	135.00	96.00	19.00	45.00	M19x1.50	2700	13500