

## FORGED EYE BOLT WITH WASHER & NUT, SS304 OR SS316

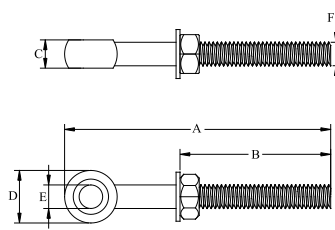

Part No. 304	Part No. 316	A mm	B mm	C mm	D mm	E mm	F mm
40940	<b>40941</b>	67.80	37.00	7.20	13.80	6.00	M6

## LAG EYE SCREW FORGED, SS304 OR SS316

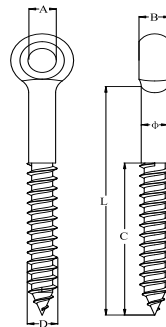

Part No. 304	Part No. 316	φ mm	A mm	B mm	C mm	D mm	L mm
-	<b>44510</b>	4.0	4.30	4.60	30.00	3.80	45.00
40914	<b>40929</b>	5.6~6	6.30	7.00	30.00	6.00	40.00
40915	<b>40930</b>	5.6~6	6.30	7.00	35.00	6.00	50.00
40916	<b>40931</b>	5.6~6	6.30	7.00	40.00	6.00	55.00
40917	<b>30047</b>	5.6~6	6.30	7.00	40.00	6.00	60.00
-	<b>44928</b>	6.00	6.50	6.00	44.00	6.00	55.00
40918	<b>30048</b>	7.6~8	8.40	9.00	40.00	8.00	60.00
40919	<b>40932</b>	7.6~8	8.40	9.00	50.00	8.00	75.00
40920	<b>40933</b>	7.6~8	8.40	9.00	55.00	8.00	80.00
40921	<b>40934</b>	7.6~8	8.40	9.00	65.00	8.00	100.00
40922	<b>40935</b>	9.6~10	10.20	11.00	50.00	10.00	75.00
40923	<b>19503</b>	9.6~10	10.20	11.00	55.00	10.00	80.00
40924	<b>40936</b>	9.6~10	10.20	11.00	60.00	10.00	85.00
40925	<b>40937</b>	9.6~10	10.20	11.00	65.00	10.00	100.00
40926	<b>40938</b>	9.6~10	10.20	11.00	80.00	10.00	120.00
40927	<b>33703</b>	11.6~12	12.10	13.00	65.00	12.00	100.00
40928	<b>40939</b>	11.6~12	12.10	13.00	80.00	12.00	120.00