

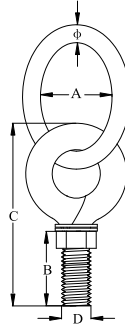

RING BOLT WITH WASHER AND NUT, SS304 OR SS316



Part No. 304	Part No. 316	φ mm	A mm	B mm	C mm	D mm	SWL kgs	BL kgs
41168	41179	5.00	30.00	40.00	60.00	M5	200	800
41169	41180	6.00	35.00	50.00	75.00	M6	250	1000
41170	41181	6.00	35.00	60.00	90.00	M6	250	1000
41171	41182	8.00	45.00	50.00	85.00	M8	450	1800
41172	41183	8.00	45.00	60.00	100.00	M8	450	1800
41173	41184	9.00	50.00	50.00	100.00	M10	600	2400
41174	41185	9.00	50.00	75.00	120.00	M10	600	2400
41164	41175	10.00	50.00	50.00	100.00	M10	600	2400
41165	41176	12.00	60.00	70.00	120.00	M12	1000	4000
41166	41177	12.00	60.00	100.00	150.00	M12	1000	4000
41167	41178	12.00	60.00	120.00	180.00	M12	1000	4000