

ENGINEERS STUDS - OLD STANDARD B.S.1083



LENGTH

DIAMETER	M8		M10	
GRADE	316/A4		316/A4	
	Part No.	PKT Qty	Part No.	PKT Qty
30	16175	50		
40	16177	50	4518	50
45	30216	50		
50			4519	50

LENGTH

DIAMETER	M12		M16	
GRADE	316/A4		316/A4	
	Part No.	PKT Qty	Part No.	PKT Qty
40	4521	25		
45	30845	25		
50	4522	25	4524	25
55	30846	25	30217	25
60	4523	25	4525	25
65			5060	25
80			4526	25

LENGTH

M20	
GRADE	316/A4
	Part No.
70	30453

SPECIFICATION B.S.1083

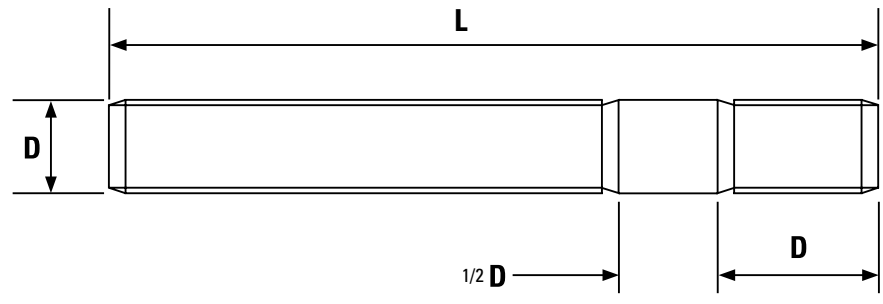

Studs - Old Standard B.S.1083
 This Standard provides that the length of the Metal or Stud End thread shall be equal to the Stud Diameter. One half of the diameter is left plain and the balance screwed.

ENGINEERS STUDS - OLD STANDARD B.S.1083

DIAMETER	5/16 BSW	3/8 BSW
GRADE	316/A4	316/A4

LENGTH

	Part No.	PKT Qty	Part No.	PKT Qty
1.1/2	16194	50	2972	50
1.3/4			2973	50
2	16195	50	2974	50
2.1/2			2976	50

DIAMETER	1/2 BSW	5/8 BSW
GRADE	316/A4	316/A4

LENGTH

	Part No.	PKT Qty	Part No.	PKT Qty
1.3/4	2980	25		
2	2981	25	2985	25
2.1/4				
2.1/2			2987	25
3			2988	25

